

REVOCABLE PERMIT AND INDEMNIFICATION AGREEMENT

THIS PERMIT TO USE THE CITY'S RIGHTS-OF-WAY OR EASEMENTS HEREIN DESCRIBED IS ISSUED BY THE CITY OF JACKSONVILLE TO THE PERMITTEE NAMED BELOW FOR THE PURPOSES HEREIN SPECIFIED UPON THE TERMS AND CONDITIONS SET FORTH BELOW AND THE GENERAL PROVISIONS ON THE REVERSE SIDE HEREOF. BY THE EXECUTION HEREOF THE PERMITTEE AGREES TO COMPLY WITH ALL SUCH TERMS, CONDITIONS AND GENERAL PROVISIONS.

Re-recorded to include Landscaping & Irrigation 9996 Page 2371

1. NAME OF RIGHT-OF-WAY: Timber Point Drive 2. DATE: 3-9-01

3. DESCRIPTION OF RIGHT-OF-WAY OR EASEMENT:
70 foot right of way at Argyle Forest Chimney Lakes Unit 19 as recorded in Plat Book 53, Pages 84, 84A - 84G

4. PURPOSE OF PERMIT AND DETAILED DESCRIPTION OF IMPROVEMENTS: (Attach Detailed Sketch of Improvements)
Install subdivision entry sign & Argyle Forest Chimney Lakes Unit 19 plus landscaping & irrigation in right-of-ways

5. PERMITTER:
CITY OF JACKSONVILLE

5a. REPRESENTATIVE: (Type Name, Title and Address)
Ed Hall
City Engineer
Department of Public Works
Doc# 2001068323
Book: 9926
Pages: 2474 - 2479
03/27/2001 11:24:06 AM
JIN FULLER
CLERK CIRCUIT COURT
DUVAL COUNTY
TRUST FUND \$ 3.50
RECORDING \$ 25.00

6. PERMITTEE:
WaterMill Master Association, Inc.

6a. REPRESENTATIVE: (Type Name, Title and Address)
Susan D. Wood, Susan D. Wood, President
4729 U.S. Highway 17, Suite 204
Orange Park, FL 32073
Tel. #: (904) 264-6553

7. GENERAL PROVISIONS: (See Reverse Side)

EXECUTION OF PERMIT

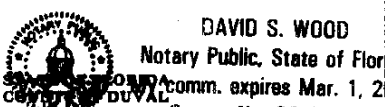
FOR	BY
CITY OF JACKSONVILLE	By: <u>Ed Hall</u> <u>3/27/01</u> <u>5/21/01</u> Date: <u>3/27/01</u> Date: <u>3/27/01</u>
 <p>DAVID S. WOOD Notary Public, State of Florida Comm. expires Mar. 1, 2008 Comm. No. CC 813321</p>	It: <u>[Signature]</u> Witness: <u>[Signature]</u> Witness: <u>[Signature]</u>

The foregoing instrument was signed before me this 27 day of March, 2001, by ED HALL
the Eng. D.V. Chief of City of Jacksonville, a municipal corporation, who executed the foregoing instrument and acknowledged the execution thereof to be his own free act and deed on behalf of the corporation.
My Commission Expires: _____
[Signature]
NOTARY PUBLIC, STATE OF FLORIDA

PERMITTEE:	Signature: <u>Susan D. Wood</u> It: <u>President</u> Date: <u>3-20-01</u>
WaterMill Master Association, Inc. STATE OF FLORIDA COUNTY OF DUVAL	Witness: <u>[Signature]</u> Witness: <u>[Signature]</u> Date: <u>3-20-01</u>

The foregoing instrument was signed before me this 20 day of March, 2001, by Susan D. Wood
(name of officer)
the President of WaterMill Master Association, Inc.
(title of officer) (name of corporation)
who executed the foregoing instrument and acknowledged the execution thereof to be his own free act and deed on behalf of the corporation.

My Commission Expires: _____

[Signature]
NOTARY PUBLIC, STATE OF FLORIDA

7. GENERAL PROVISIONS:

Book 9996 Page 2372

- (a) City hereby permits Permittee to use the property described in item 3 for the purposes set forth in item 4 and in accordance with the detailed sketch attached thereto.
- (b) Permittee shall maintain, at its sole cost and expense, the improvements set forth in item 4 and the detailed sketch, in a good, safe and attractive condition.
- (c) Permittee shall repair, at its sole cost and expense, any and all damage, if any, to the property described in item 3, resulting from its use of said property.
- (d) This Permit is revocable at any time, upon giving 30 days notice to Permittee, at the option and discretion of City or its duly authorized representative.
- (e) In the event that the City revokes this permit, Permittee shall immediately remove at its cost and expense the improvements described in item 4 and shown on the detailed sketch in the right of way or easement and Permittee shall at Permittee's expense restore the right-of-way to its condition prior to installation of the improvements; provided, that if Permittee shall fail to do so or fail to do so in a manner that does not interfere with the City's use of the right of way or easement, then the City may perform such removal at the cost and expense of Permittee.
- (f) Permittee shall act as an independent contractor, and not as an employee of the City in performing its obligations pursuant to this Agreement. Permittee shall be solely liable, and agrees to be solely liable for, and shall indemnify, defend and hold City harmless from any and all loss, damage, action, claim, suit, judgment, cost or expense for injury to persons (including death) or damage to property (including destruction) in any manner resulting from or arising out of the installation, maintenance (failure to maintain), use or existence of the improvements described in item 4 and shown on the detailed sketch within City's right of way or easement. The foregoing shall include any damage incurred by Permittee or to the improvements due to the removal of the improvements by City or Permittee; as well as any damage caused by the forces of any natural occurrence.
- (g) Permittee further agrees that, in the event City requires access to any area of the right of way or easement, necessitating the removal of and/or damage to any or all of said improvements, Permittee shall remain solely responsible at its cost and expense for any necessary repairs to or replacement of said improvements in order to return the right of way or easement to its original condition, or to other conditions meeting City standards or requirements for the right of way or easement.
- (h) Upon complete execution hereof, Permittee shall record at its cost and expense this permit with the Clerk of the Circuit Court in the official records of Duval County, Florida, and shall provide to the City a copy of the duly recorded permit showing on the face of it the appropriate recording stamp of said Clerk showing the book and page number in and at which it was recorded.

BUILDING PLANS EXAMINER
REVIEWED FOR
CODE COMPLIANCE
KEEP THIS PLAN ON JOB
MAR 09 2001

Building & Zoning Inspection Div-Jax., FL
Examiner Signature
Case No.

1

VIEW AND ISSUING
IT DOES NOT RELIEVE
OR OF COMPLYING
CODES

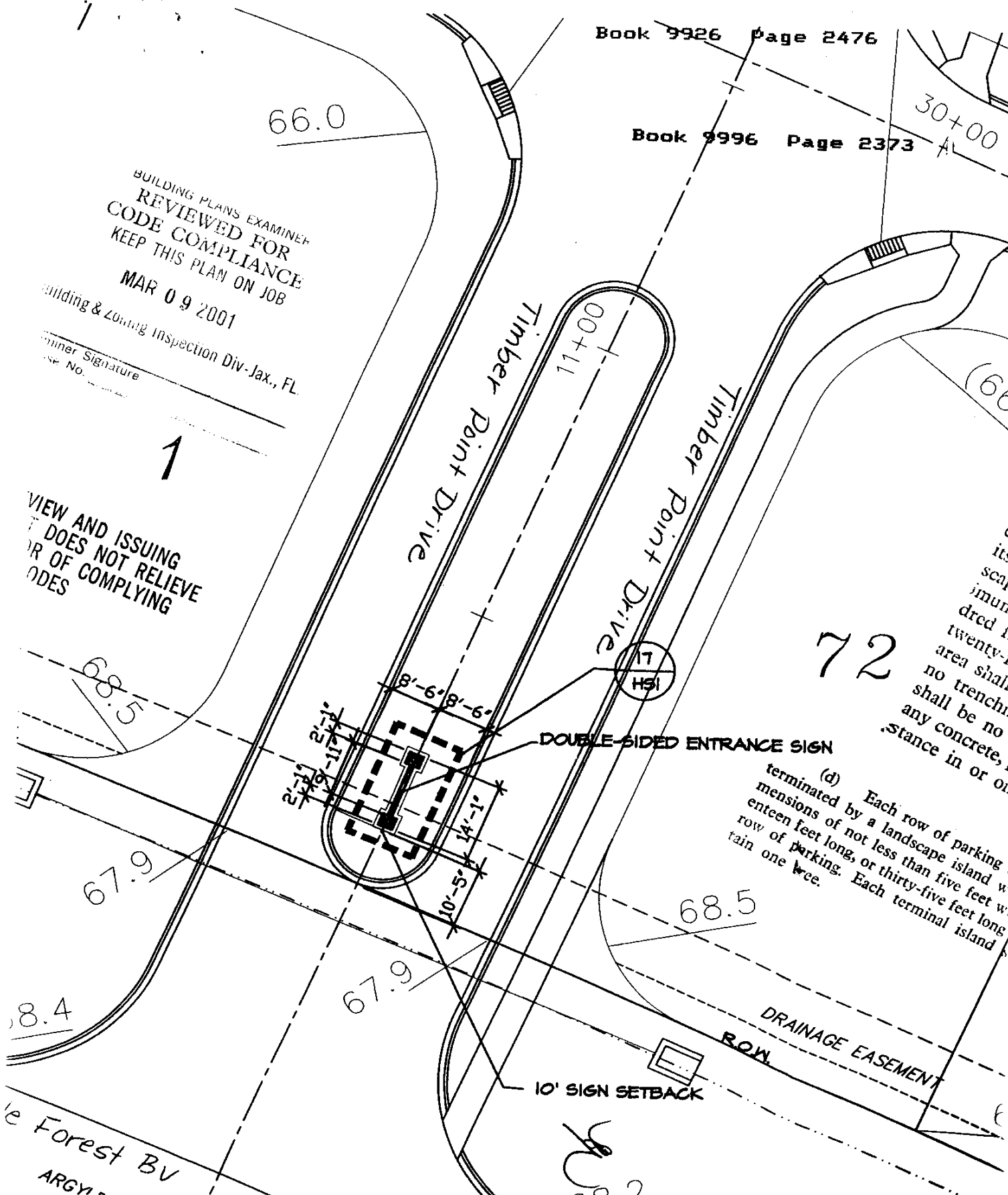

DOUBLE-SIDED ENTRANCE SIGN

10' SIGN SETBACK

DRAINAGE EASEMENT

R.O.W.

72

(d) Each row of parking shall be terminated by a landscape island with dimensions of not less than five feet wide, fifteen feet long, or thirty-five feet long row of parking. Each terminal island shall contain one tree.

le Forest BV
ARGY

INITIAL SITE PLAN

68.2

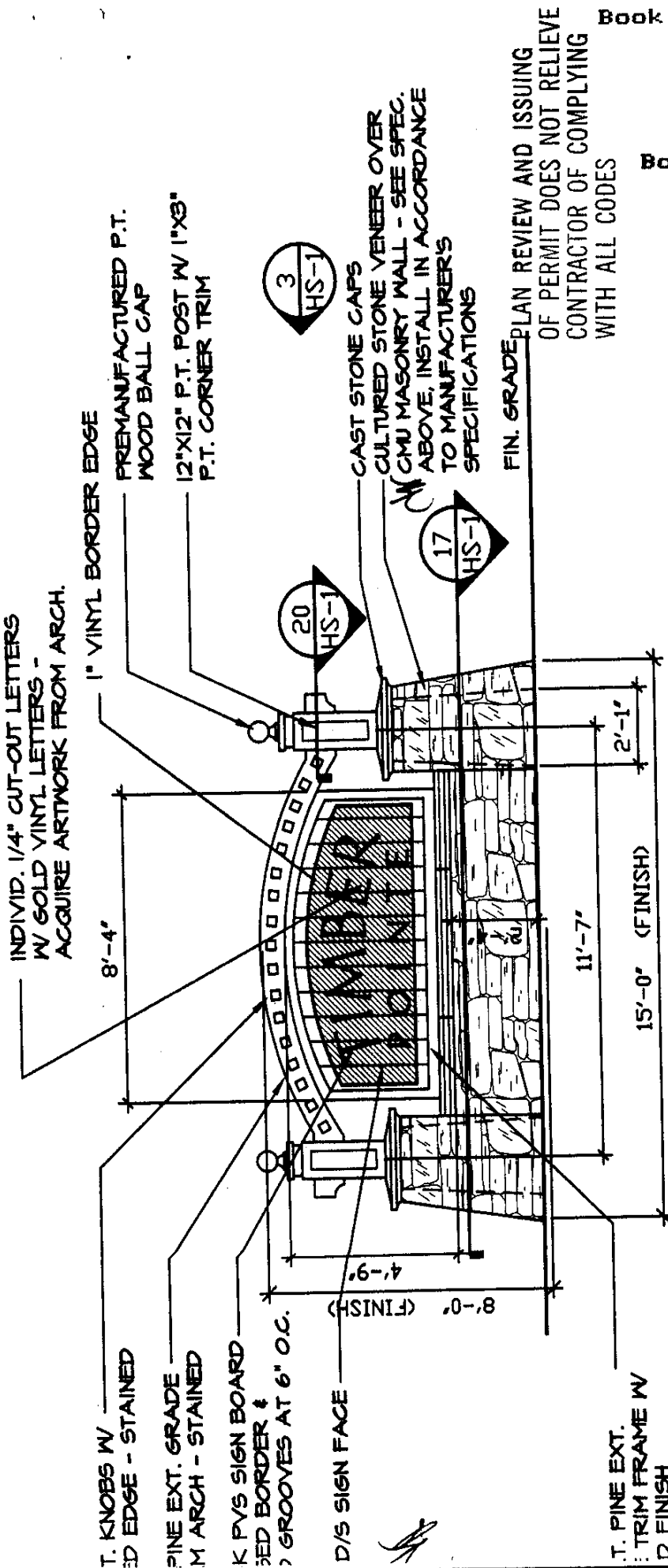

TIMBER POINTE
SCALE: 1/4" = 1'-0"

2

INDIVID. 1/4" CUT-OUT LETTERS
 W/ GOLD VINYL LETTERS -
 ACQUIRE ARTWORK FROM ARCH.

8'-4"

1" VINYL BORDER EDGE

T. KNOBS W/
 ED EDGE - STAINED
 PINE EXT. GRADE
 M ARCH - STAINED

K PYS SIGN BOARD
 ED BORDER &
 GROOVES AT 6" O.C.

8'-0" (FINISH)

D/S SIGN FACE

4'-9"

11'-7"
 15'-0" (FINISH)

T. PINE EXT.
 TRIM FRAME W/
 D FINISH

2'-1"

3
 HS-1

CAST STONE CAPS
 CULTURED STONE VENEER OVER
 CMU MASONRY WALL - SEE SPEC.
 ABOVE, INSTALL IN ACCORDANCE
 TO MANUFACTURER'S
 SPECIFICATIONS

17
 HS-1

FIN. GRADE
 PLAN REVIEW AND ISSUING
 OF PERMIT DOES NOT RELIEVE
 CONTRACTOR OF COMPLYING
 WITH ALL CODES

Book 9996

TOTAL: 2 SIGNS - DOUBLE-SIDED.

10'X6" PINE EXT. GRADE
 GLU-LAM ARCH - STAINED

PREMANUFACTURED P.T.
 WOOD BALL CAP

12'X12" P.T. POST W 1"X3"
 P.T. CORNER TRIM - PAINTED

TRIM FRAME W/ FINISH

15'-0" (FINISH)

2'-1"

TIMBER POINTE

SCALE: 1/4" = 1'-0"

2

TOTAL: 2 SIGNS - DOUBLE-SIDED.

Book 9996 Page 2375

10'X6" PINE EXT. GRADE GLU-LAM ARCH - STAINED

PREMANUFACTURED P.T. WOOD BALL CAP

12'X12" P.T. POST W/ 1'X3" P.T. CORNER TRIM - PAINTED

CAST STONE CAPS

CULTURED STONE VENEER OVER CMU MASONRY WALL - SEE SPEC. ABOVE

BUILDING PLANS EXAMINER
REVIEWED FOR
CODE COMPLIANCE
KEEP THIS PLAN ON JOB

MAR 09 2001

Building & Code Enforcement Div. - Jacksonville, FL

Book 9926

Examiner Signature
License No.

PLAN REVIEW AND ISSUING
OF PERMIT DOES NOT RELIEVE
CONTRACTOR OF COMPLYING
WITH ALL CODES

46 FIC
2478

SIGN SIDE VIEW

SCALE: 1/4" = 1'-0"

3

VARIANCES OR HOLD
TION OF THESE SIGNS.
AND STATE
ONSTRUCTION.
LOPOULOS AND ASSOCIATES.
BEFORE CONSTRUCTION BEGINS.

BUILDING PLANS EXAMINER
REVIEWED FOR
CODE COMPLIANCE
KEEP THIS PLAN ON JOB

MAR 09 2001

Book 9926 Page 2479

Building & Zoning Inspection Div-Jax., FL.

Examiner Signature
License No.

PLAN REVIEW AND ISSUING
OF PERMIT DOES NOT RELIEVE
CONTRACTOR OF COMPLYING
WITH ALL CODES

Book 9996 Page 2376

000-92871

F 2500 P.S.I.

TANDARD BLDG.

L REQ'D.

STONE BY L&S
PECIFICATIONS.
ERIC

PAINTED W (2)

GLU-LAM ARCH AS
ATION.
D AND PAINTED

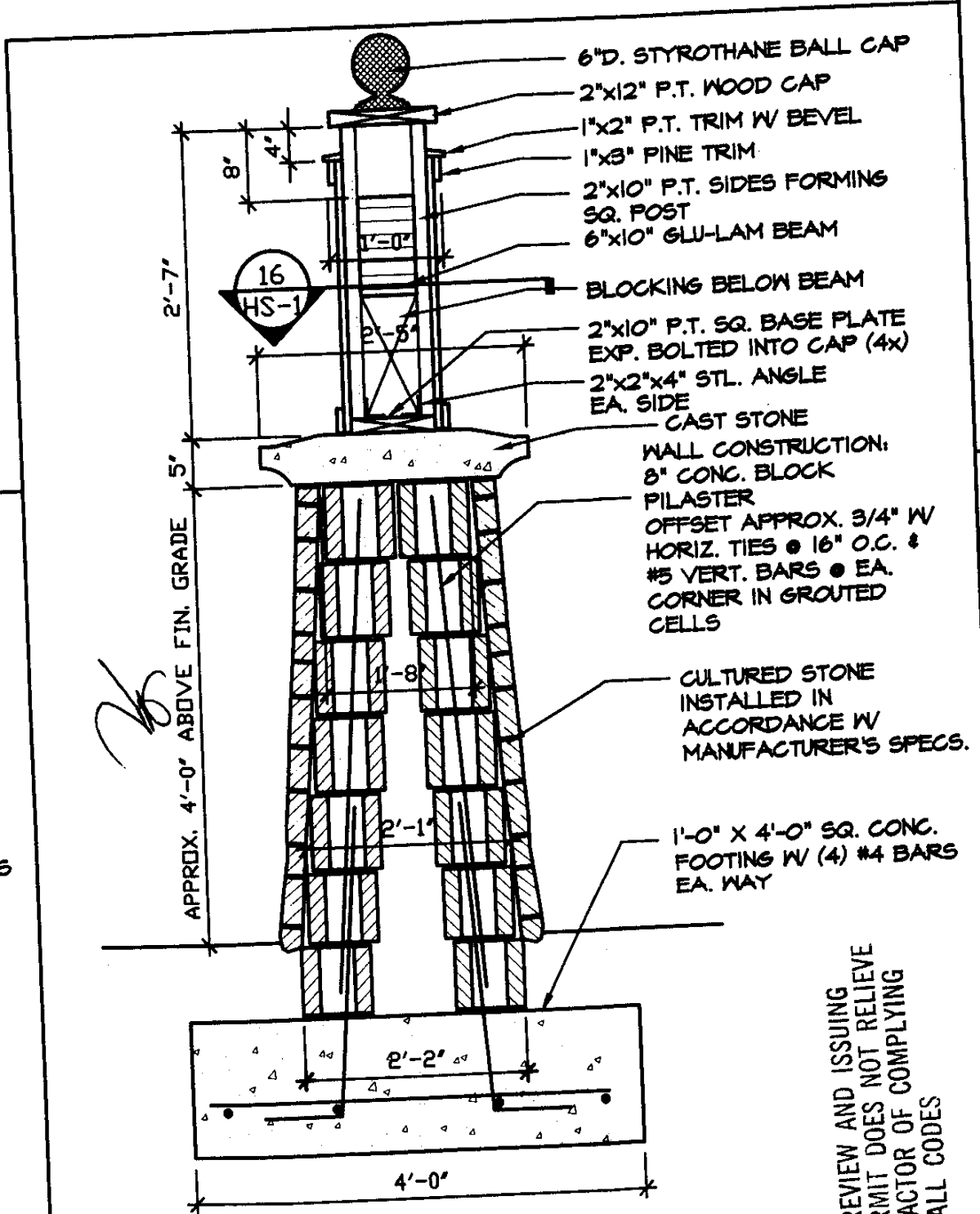

19 SIGN PILASTER

SCALE: 3/4" = 1'-0"

PLAN REVIEW AND ISSUING
OF PERMIT DOES NOT RELIEVE
CONTRACTOR OF COMPLYING
WITH ALL CODES

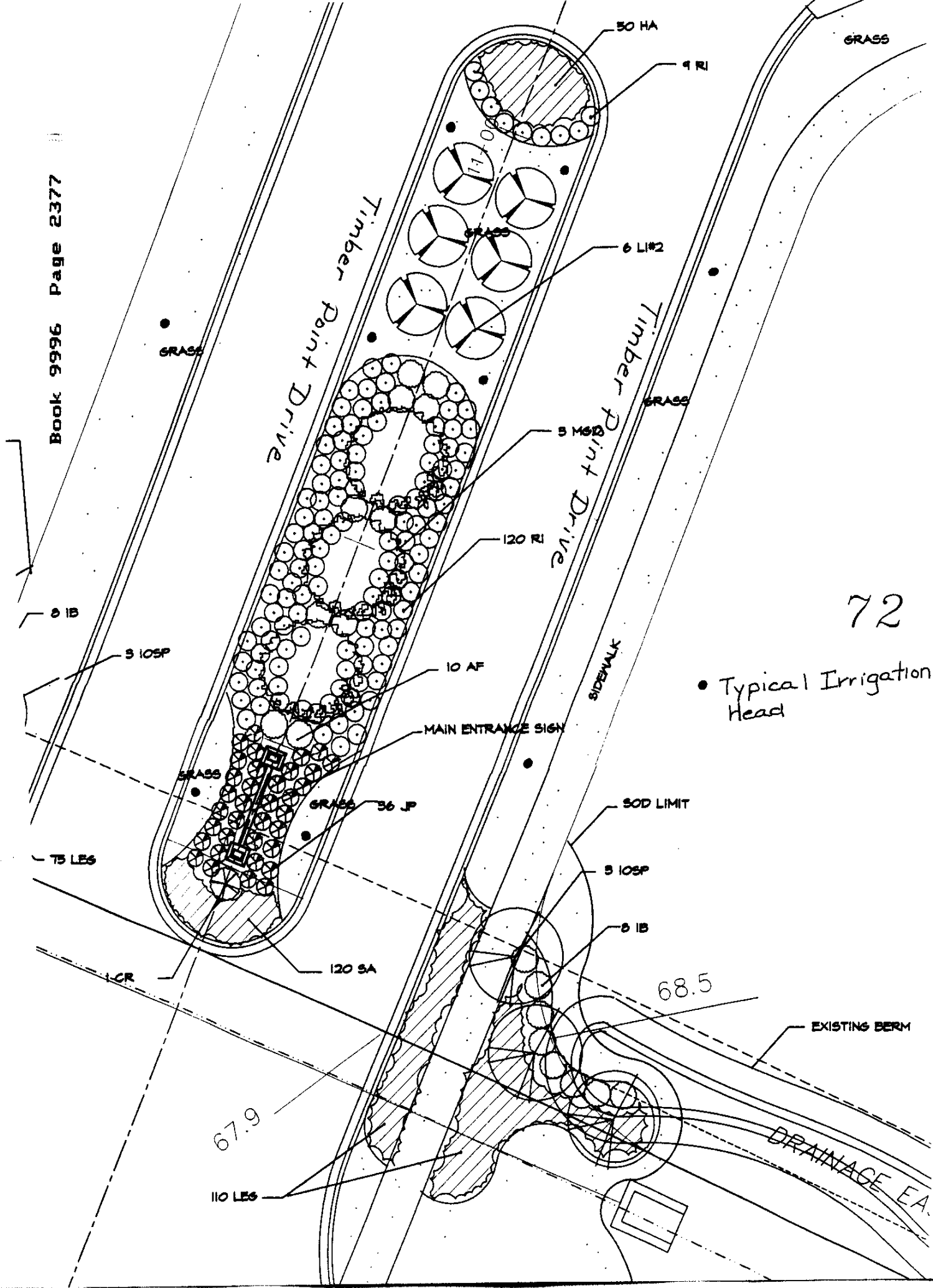

72

• Typical Irrigation Head

67.9

68.5

1 CR

75 LES

110 LES

GRASS 36 JP

MAIN ENTRANCE SIGN

SIDEWALK

SOD LIMIT

5 IOSP

5 IB

120 SA

5 IOSP

120 RI

5 MSB

6 LI#2

9 RI

50 HA

GRASS

GRASS

GRASS

GRASS

DRAINAGE EA.

EXISTING BERM

ARCYLE FOREST

Doc# 2001120650
 Book: 9996
 Pages: 2371 - 2378
 Filed & Recorded
 05/21/2001 10:48:29 AM
 JIM FULLER
 CLERK CIRCUIT COURT
 DUVAL COUNTY
 TRUST FUND \$ 4.50
 RECORDING \$ 33.00

